



Title Plan - LT 626658

Survey Number LT 626658
Surveyor Reference E21373 Rosemerryn S24
Surveyor Nicholas Johan Jagvik
Survey Firm Davie Lovell-Smith Ltd
Surveyor Declaration I Nicholas Johan Jagvik, being a licensed cadastral surveyor, certify that--
(a) this dataset provided by me and its related survey are accurate, correct and in accordance with the Cadastral Survey Act 2002 and Cadastral Survey Rules 2021; and
(b) the survey was undertaken by me or under my personal direction.
Declared on 07 May 2026 03:54 PM

Survey Details

Dataset Description Lots 902-915, 964-979, 982-988, 1032, 6005 & 7023 being subdivision of Lot 8006 DP 621309
Status Approved as to Survey
Land District Canterbury **Survey Class** Class A
Submitted Date 07/05/2026 **Survey Approval Date** 11/05/2026
Deposit Date

Territorial Authorities

Selwyn District

Comprised In

RT 1255699

Created Parcels

Parcels	Parcel Intent	Area	RT Reference
Lot 902 Deposited Plan 626658	Fee Simple Title	0.1074 Ha	1277999
Lot 903 Deposited Plan 626658	Fee Simple Title	0.1200 Ha	1278000
Lot 904 Deposited Plan 626658	Fee Simple Title	0.1117 Ha	1278001
Lot 905 Deposited Plan 626658	Fee Simple Title	0.1037 Ha	1278002
Lot 906 Deposited Plan 626658	Fee Simple Title	0.1046 Ha	1278003
Lot 907 Deposited Plan 626658	Fee Simple Title	0.1190 Ha	1278004
Lot 908 Deposited Plan 626658	Fee Simple Title	0.1473 Ha	1278005
Lot 909 Deposited Plan 626658	Fee Simple Title	0.1062 Ha	1278006
Lot 910 Deposited Plan 626658	Fee Simple Title	0.0780 Ha	1278007
Lot 911 Deposited Plan 626658	Fee Simple Title	0.0780 Ha	1278008
Lot 912 Deposited Plan 626658	Fee Simple Title	0.0770 Ha	1278009
Lot 913 Deposited Plan 626658	Fee Simple Title	0.0770 Ha	1278010
Lot 914 Deposited Plan 626658	Fee Simple Title	0.0770 Ha	1278011
Lot 915 Deposited Plan 626658	Fee Simple Title	0.0762 Ha	1278012
Lot 964 Deposited Plan 626658	Fee Simple Title	0.0567 Ha	1278013
Lot 965 Deposited Plan 626658	Fee Simple Title	0.0567 Ha	1278014
Lot 966 Deposited Plan 626658	Fee Simple Title	0.0567 Ha	1278015
Lot 967 Deposited Plan 626658	Fee Simple Title	0.0567 Ha	1278016
Lot 968 Deposited Plan 626658	Fee Simple Title	0.0567 Ha	1278017
Lot 969 Deposited Plan 626658	Fee Simple Title	0.0567 Ha	1278018

Title Plan - LT 626658

Created Parcels

Parcels	Parcel Intent	Area	RT Reference
Lot 970 Deposited Plan 626658	Fee Simple Title	0.0567 Ha	1278019
Lot 971 Deposited Plan 626658	Fee Simple Title	0.0634 Ha	1278020
Lot 972 Deposited Plan 626658	Fee Simple Title	0.0540 Ha	1278021
Lot 973 Deposited Plan 626658	Fee Simple Title	0.0527 Ha	1278022
Lot 974 Deposited Plan 626658	Fee Simple Title	0.0527 Ha	1278023
Lot 975 Deposited Plan 626658	Fee Simple Title	0.0558 Ha	1278024
Lot 976 Deposited Plan 626658	Fee Simple Title	0.0558 Ha	1278025
Lot 977 Deposited Plan 626658	Fee Simple Title	0.0558 Ha	1278026
Lot 978 Deposited Plan 626658	Fee Simple Title	0.0558 Ha	1278027
Lot 979 Deposited Plan 626658	Fee Simple Title	0.0558 Ha	1278028
Lot 982 Deposited Plan 626658	Fee Simple Title	0.0542 Ha	1278029
Lot 983 Deposited Plan 626658	Fee Simple Title	0.0558 Ha	1278030
Lot 984 Deposited Plan 626658	Fee Simple Title	0.0558 Ha	1278031
Lot 985 Deposited Plan 626658	Fee Simple Title	0.0558 Ha	1278032
Lot 986 Deposited Plan 626658	Fee Simple Title	0.0558 Ha	1278033
Lot 987 Deposited Plan 626658	Fee Simple Title	0.0558 Ha	1278034
Lot 988 Deposited Plan 626658	Fee Simple Title	0.0682 Ha	1278035
Lot 1032 Deposited Plan 626658	Vesting on Deposit for Local Purpose Reserve	0.1161 Ha	1278036
Lot 6005 Deposited Plan 626658	Fee Simple Title	0.0006 Ha	1278037
Lot 7023 Deposited Plan 626658	Vesting on Deposit for Road	0.6229 Ha	
Area A Deposited Plan 626658	Easement		
Area B Deposited Plan 626658	Easement		
Area C Deposited Plan 626658	Easement		
Total Area		3.4228 Ha	

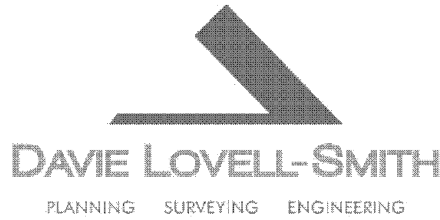

Davie Lovell-Smith Ltd
 116 Wrights Road, Addington
 PO Box 679, Christchurch 8140
 New Zealand
 Telephone (03) 379 0793
 E-mail: office@dls.co.nz

Surveyor Reference: E21373 Rosemerryn S24

DP 626658

MEMORANDUM OF EASEMENTS

Purpose	Servient Tenement (Burdened Land)	Shown	Dominant Tenement (Benefited Land)
Right of way, right to drain water & sewage, right to convey water, electricity & telecommunications	Lot 908	A	Lot 909
	Lot 909	B	Lot 908

MEMORANDUM OF EASEMENTS IN GROSS

Purpose	Servient Tenement (Burdened Land)	Shown	Grantee
Right to drain sewage in gross	Lot 908	A	Selwyn Water Limited
	Lot 909	B	

SCHEDULE OF EASEMENTS IN GROSS

Purpose	Servient Tenement (Burdened Land)	Shown	Grantee
Right to convey telecommunications in gross	Lot 908	A	Enable Networks Limited
	Lot 909	B	
	Lot 1032	C	

SCHEDULE OF EXISTING EASEMENTS TO BE SURRENDERED

Purpose	Servient Tenement (Burdened Land)	Shown	Document
Right to drain sewage and water in gross	Lot 8006 DP 621309	Marked H & I on DP 621309	EI 13275969.6



Diag. A

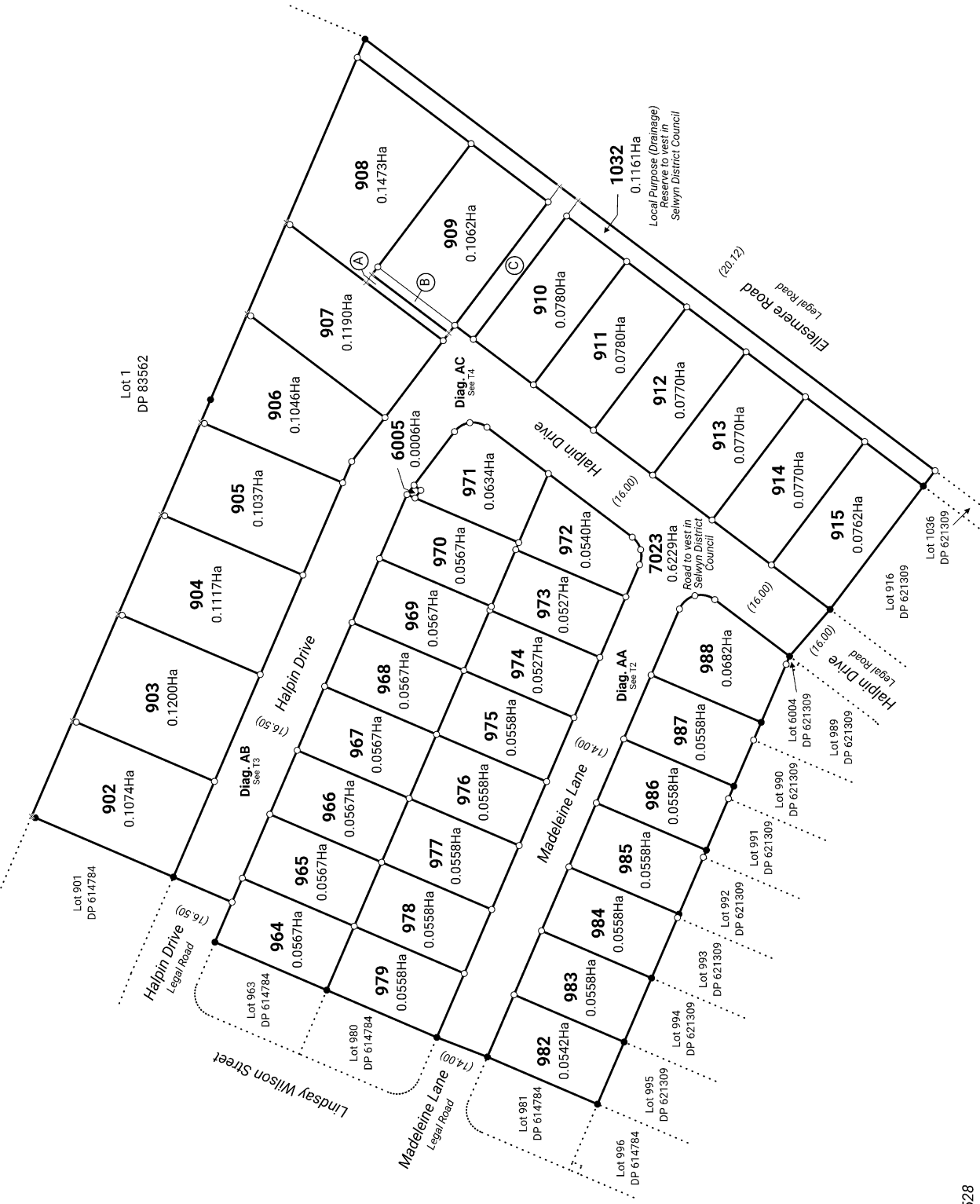

E21373
RCs 225391 & 235528

T 1/4

Land District: Canterbury

Digitally Generated Plan
Generated on: 11/05/2026 11:27am Page 4 of 7

Lots 902-915, 964-979, 982-988, 1032, 6005 & 7023 being subdivision of Lot 8006 DP 621309

Surveyor: Nicholas Johan Jagvik
Firm: Davie Lovell-Smith Ltd

Title Plan
LT 626658
Approved on: 11/05/2026

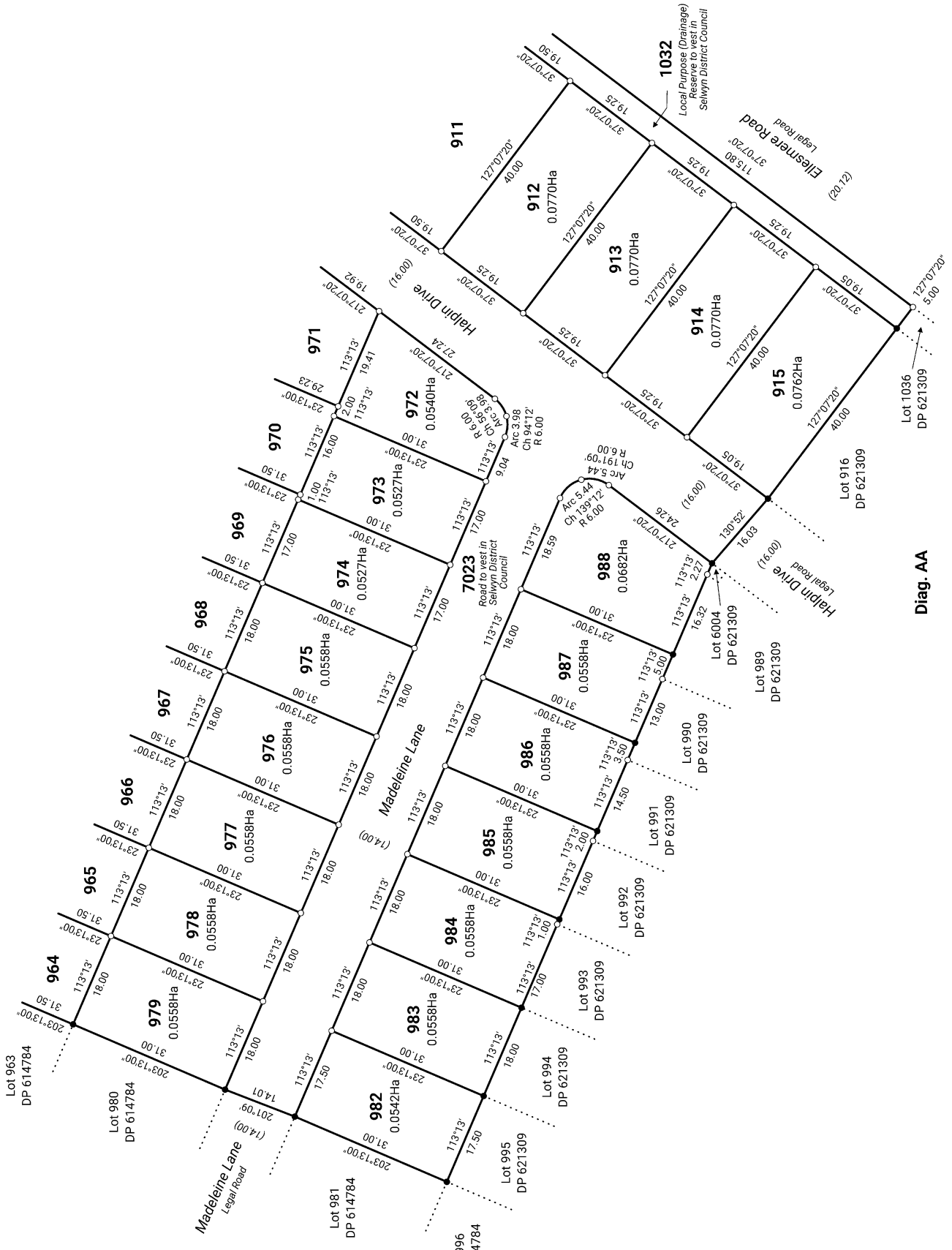

Diag. AA

Lots 902-915, 964-979, 982-988, 1032, 6005 & 7023 being subdivision of Lot 8006 DP 621309

Surveyor: Nicholas Johan Jagvik
Firm: Davie Lovell-Smith Ltd

Title Plan
LT 626658
Approved on: 11/05/2026



Diag. AC

T 4/4

Land District: Canterbury

Digitally Generated Plan

Generated on: 11/05/2026 11:27am Page 7 of 7

Lots 902-915, 964-979, 982-988, 1032, 6005 & 7023 being subdivision of Lot 8006 DP 621309

Surveyor: Nicholas Johan Jagvik
Firm: Davie Lovell-Smith Ltd

Title Plan
LT 626658
Approved on: 11/05/2026